

Bali 4.0 Lounge - Kastela

Technical specification



| | |
|---------------------|-------------|
| Year of production: | 2017 |
| Length over all: | 11.93 |
| Beam: | 6.72 |
| Draft: | 1.12 |
| Displacement: | 11200 |
| Engine: | 2 x 40 hp |
| Fuel tank: | 2 x 200 L |
| Water tank: | 2 x 400 L |
| Cabins: | 4 |
| Berths: | 8+2 |
| Showers/Toilets: | 4 |
| Main sail: | Full batten |
| Genoa: | Roll |

Description

The BALI 4.0 is characterized by a single cockpit / saloon area, entirely flush and unencumbered by bulkheads, accessible via an immense folding glass door on electric rams. So in the blink of an eye you can switch from Cosy mode to Lounge mode, with a panoramic view over sea... A forward cockpit with dining area as well as an immense sunbathing area in place of the traditional trampoline Extra living space wai sunbathing area on the coachroof As with its big brothers, the BALI 4.5 Open Space and the BALI 4.3 Loft, the BALI 4.0 enjoys an extraordinary amount of natural light. The large retractable windows bring an unequalled freshness into the saloon as well as a panoramic view. The many hatches in the hulls ensure exceptional natural ventilation. Its technical equipment will satisfy the most exacting sailors, an then for the most exacting cook, forward is the latest generation fitted galley allowing you to cook with a sea view. With tanks for up to 800 litres of water and 400 litres of diesel, a huge fridge and deep freezer, an outsized battery bank, all controlled using a multiplexing touch screen with integrated tutorial, the latest generation fitted galley and its light weight (8.6 T), the BALI 4.0 will take you further than you ever dreamed possible.

Charter Price list

| | | | | | | | | | | | | |
|----------|-----------|-----------|-----------|----------|----------|-----------|----------|----------|-----------|-----------|-----------|------------|
| 1.1-29.4 | 29.4-20.5 | 20.5-27.5 | 27.5-17.6 | 17.6-1.7 | 1.7-22.7 | 22.7-19.8 | 19.8-2.9 | 2.9-16.9 | 16.9-23.9 | 23.9-30.9 | 30.9-7.10 | 7.10-31.12 |
| 2420€ | 2840€ | 3980€ | 4890€ | 5540€ | 6280€ | 6640€ | 6080€ | 5540€ | 4890€ | 3980€ | 2840€ | 2420€ |

Included in price:

Onboard accommodation (€/week), VAT, Anchor windlass, Autopilot, GPS plotter, CD-player & cockpit speakers, Dinghy, Fully equipped galley

Extras:

Compulsory extras

Transit log (includes final cleaning, bedlinen, cooking gas): € 180.-/charter

Residence tax: € 1.-/day/person

Optional extras

Skipper: € 160.-/day + provisioning
Hostess: € 125.-/day + provisioning
Outboard engine 2,5 hp/5 hp: € 90./120 -/week
Gennaker / Spinnaker: € 160.-/week + deposit(€ 750)
RIB 3,6 m with console and 25 HP outboard: € 490.-/week + deposit(€ 500)
RIB 3m and 15m HP outboard: € 260.-/week + deposit(€ 300)
WiFi router (5 connections): € 30.-/week
Cockpit cushions (set): € 25.-/week
Towels(2 pcs): € 5.-/charter
Kayak(2+1 person): € 100.-/week
SUP(stand up paddle): € 120.-/week
Sub wing: € 40.-/week
Wakeboard: € 40.-/week
Early Check In (at 13:00h): € 150.-/charter

Boat equipment

Navigation equipment

Autopilot, GPS plotter in cockpit, Tridata, VHF radio, Radar, Charts & Pilot books

Deck

Electric halyard winch, Sprayhood, Bimini top, Cockpit table, Cockpit speakers, Cockpit shower, Dinghy

Interior

Radio/CD player, Battery charger, Inverter 12V to 220V, Gas stove and oven, Electric refrigerator, Freezer, Galley equipment, Bedlinen, Hot water system



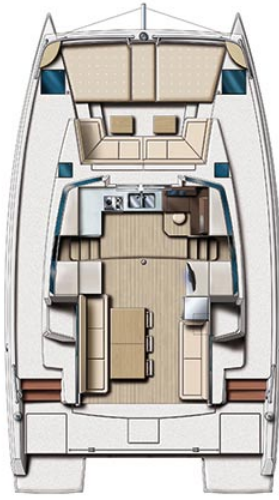
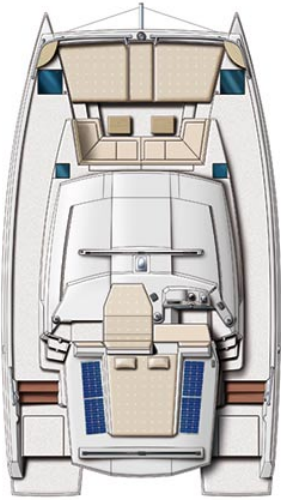
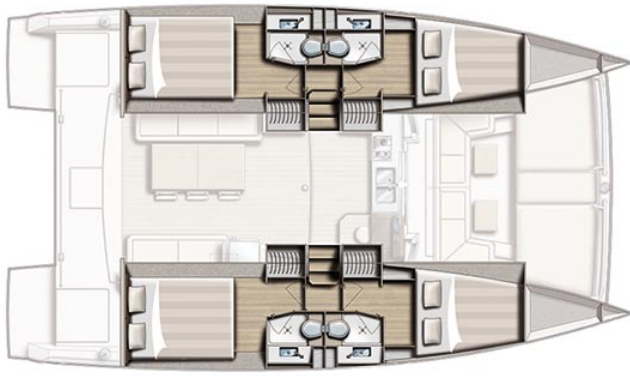



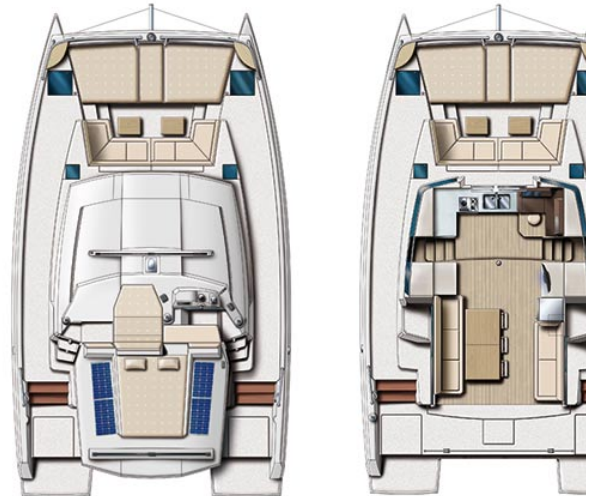

NOTE: The yacht particulars displayed in the results above are displayed in good faith and whilst believed to be correct are not guaranteed. All information is subject to change without notice and is without warranty. Exact pricing and yacht particulars will be confirmed by Croatian Yachting staff upon your booking enquire.